

# STAGE 8

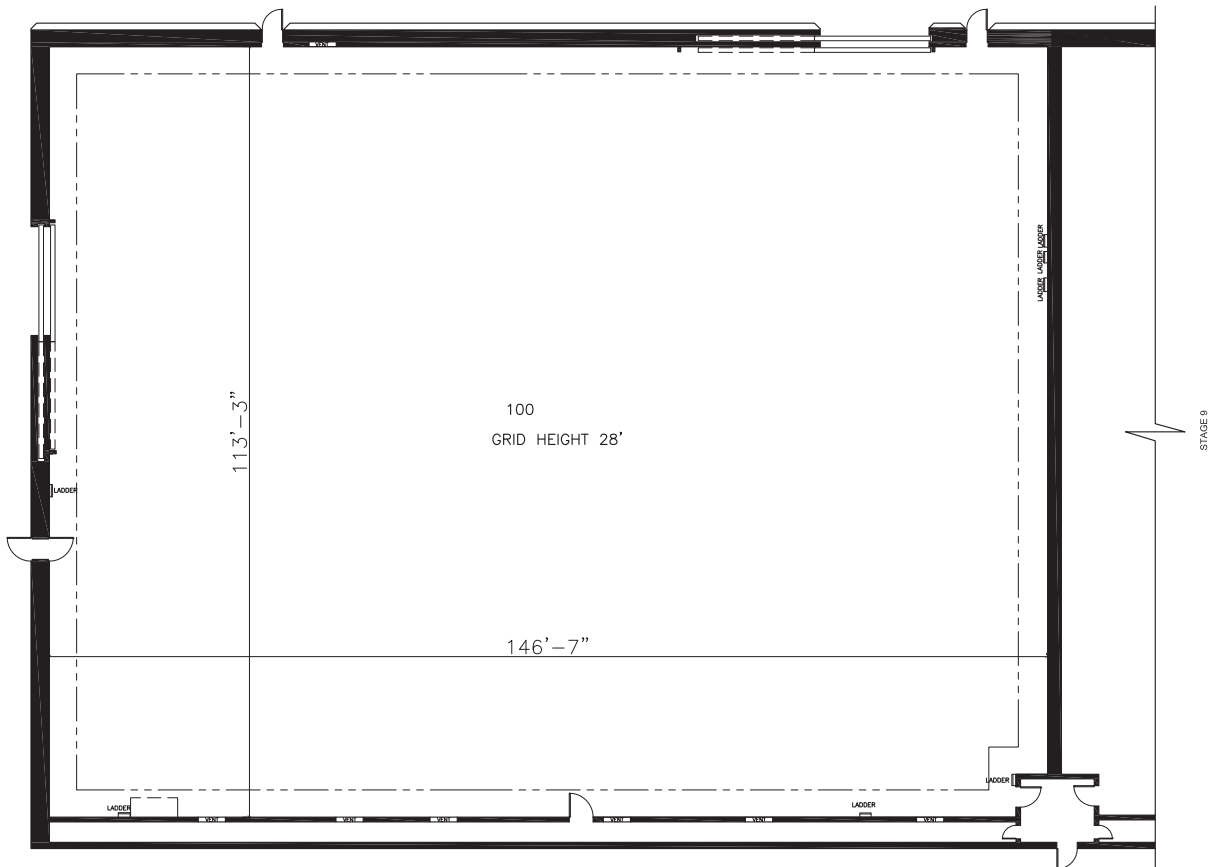

## FLOORPLAN



### DIMENSIONS

Width	113'-3"
Length	146'-7"
Height	30'
Square Feet	16,594
Door Height	26' & 27'
Max Weight Capacity	10,000lbs

### PREVIOUS PRODUCTIONS SHOT ON THIS STAGE:

#### Movies

Darling Lili (1970)  
 Rosemary's Baby (1968)  
 Going My Way (1944)  
 Lady Sings the Blues (1972)  
 Seven Days In May (1964)  
 Breakfast at Tiffany's (1961)  
 But Not For Me (1959)  
 Houseboat (1958)  
 The Matchmaker (1958)  
 Road to Bali (1952)  
 Detective Story (1951)

#### Television

Star Trek Voyager  
 Star Trek: The Next  
 Generation  
 Star Trek  
 (Original Series)  
 Star Trek Enterprise

# STAGE 8



## STAGE LOCATION

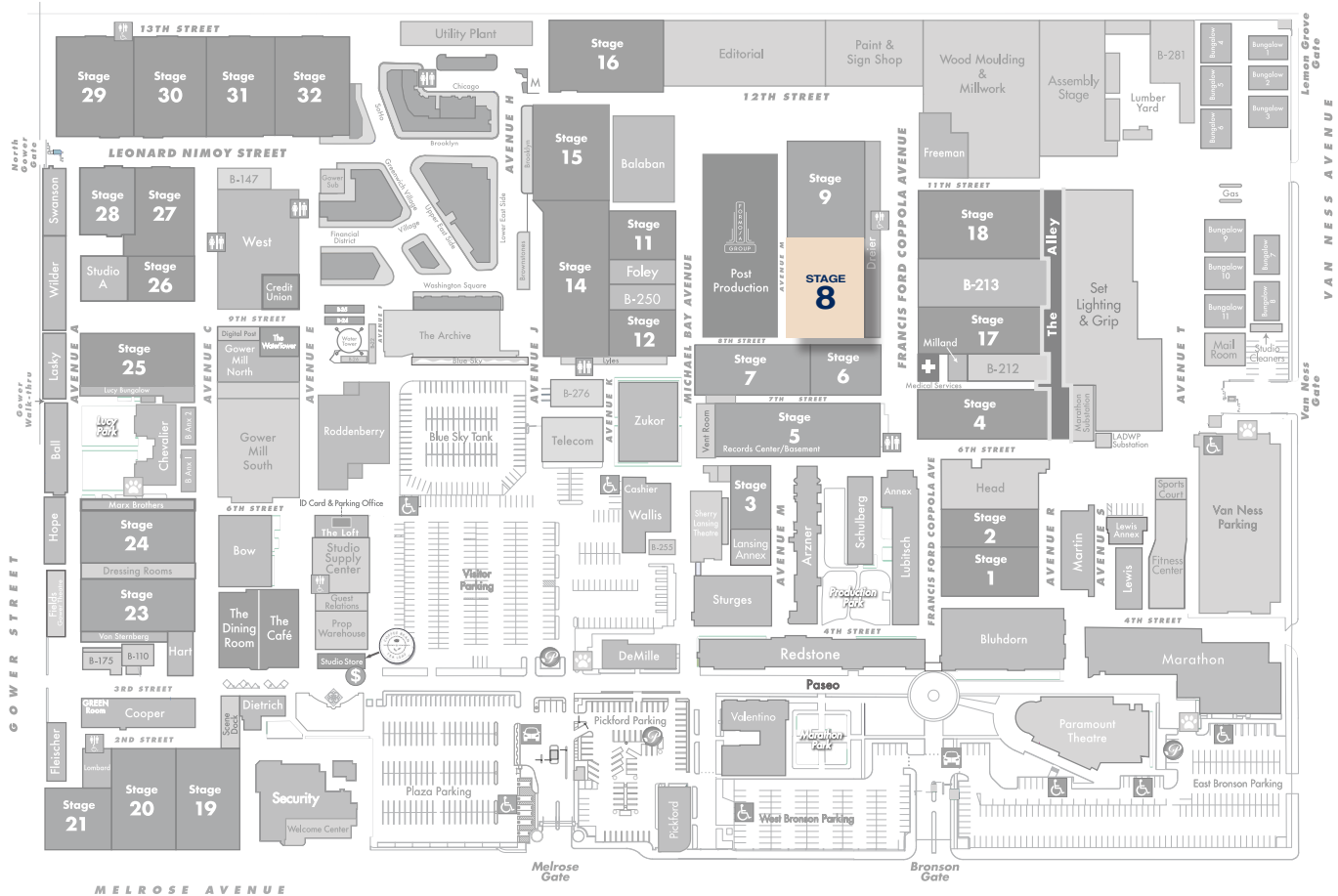

## SPECIFICATIONS

<b>Power*</b>	<b>3,600A</b>
<b>HVAC</b>	<b>200T</b>
<b>Red Light Controlled</b>	<b>Yes</b>
<b>Heat</b>	<b>Yes</b>
<b>Utilities (Air at 90PSI)</b>	<b>G/W/A</b>
<b>Wi-Fi Internet Access</b>	

\* (IP2W fixed AC power (cam locks) available as 120/208V 3P4W)